

THOMAS GREEN & SON LTD.

SMITHFIELD IRONWORKS,
LEEDS, 2

Telegrams :
SMITHFIELD LEEDS

Telephone :
LEEDS 20357

NEW SURREY WORKS,
LONDON, S.E.1

Telegrams :
SURREY WORKS LONDON

Telephone :
LONDON WATERLOO 4301

Working Instructions for "Monitor" '58 Hand Mowers (12" width of cut)

All machines, when sent out, have the cutters properly adjusted for mowing, and they should in every instance be tried first upon a lawn before attempting any alterations.

Before cutting, see that the lawn is clear of stones, etc.

ADJUSTMENT FOR HEIGHT OF CUT (see Fig. 1).

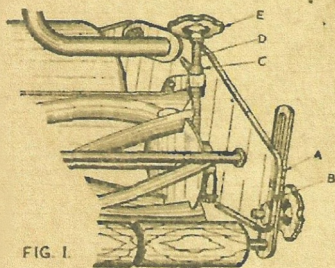

All adjustment for height of cut is obtained by vertical movement of the front roller fixings, which are graduated at 'A,' and should be adjusted in line with the hole in front edge of side-plate at 'B.' Raising the fixings gives a closer cut; by lowering them the grass is not cut so close to the ground.

Note—For ornamental lawns it is recommended that a medium cut be used, because this will help to prevent scorching in hot, dry weather and will encourage healthy growth.

To ensure the machine is level see that the corresponding notch is in line at each side.

When adjusting make sure that the machine is not adjusted below the lowest graduation on the front roller fixings. Care must be taken to lock the nuts after adjustment.

ADJUSTMENT OF CUTTING CYLINDER (see Fig. 1).

To adjust the cutting cylinder to the bottom blade, release the locknuts 'C' on the adjusting screws 'D,' and turn the screws clockwise by means of a spanner to bring the cutting cylinder lightly and evenly in contact with the bottom blade over the whole width.

Tighten the locknuts after adjusting.

Caution—Cutting cylinder should not be adjusted hard onto the bottom blade.

Continued on back

PUSHING HANDLE.

Pushing handle can be adjusted for height by releasing the bolts and nuts, and raising or lowering to suit the operator.

LUBRICATION.

1. Oil the Cutting Cylinder Bearings and Drumshaft Bearings once a week (2 points each).
2. Oil the Front Rollers weekly (at the end of each roller).
3. Keep the Chain clean and well oiled. (Take off cover.)

To ensure good service from the machine it should be thoroughly cleaned and the cutting edges greased after use.

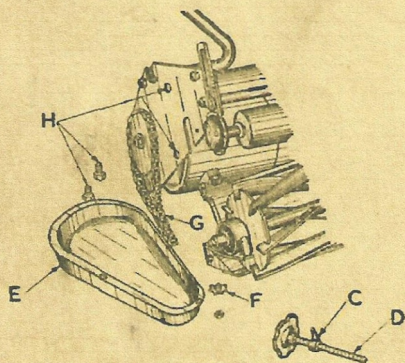

FIG. 2

DISMOUNTING CUTTING CYLINDER ASSEMBLY (see Fig. 2).

This assembly is detachable without dismantling the Mower.

1. Release locking levers 'C' and remove adjusting screws 'D'.
2. Take off the chain case 'E', pinion 'F', and chain 'G'.
3. Unscrew the two set-screws 'H' holding soleplate at each side of machine, and the whole unit will come away from machine.

Guarantee

In lieu of any warranty implied by law, we guarantee that the materials used in the manufacture of our machinery shall be of suitable quality of their respective kinds. Should any defect occur and the part be returned immediately to our Works, carriage paid, we will repair it or replace it, at our option, free of charge, and deliver it to any Station in the United Kingdom, or F.O.B. English Port, provided we are satisfied that the defect is due to faulty material or workmanship.

This guarantee does not cover wear and tear, or damage due to improper adjustment, misuse, neglect, or accident, nor does it apply to components of any make other than our own, but we will pass on to the customer the benefits of any Makers' guarantee covering such components.

Our liabilities shall not exceed those stated above, and shall not include any consequential loss, damage or responsibility.

THOMAS GREEN & SON, LIMITED

SPARE PARTS LIST FOR MONITOR '58 HAND MOWER.

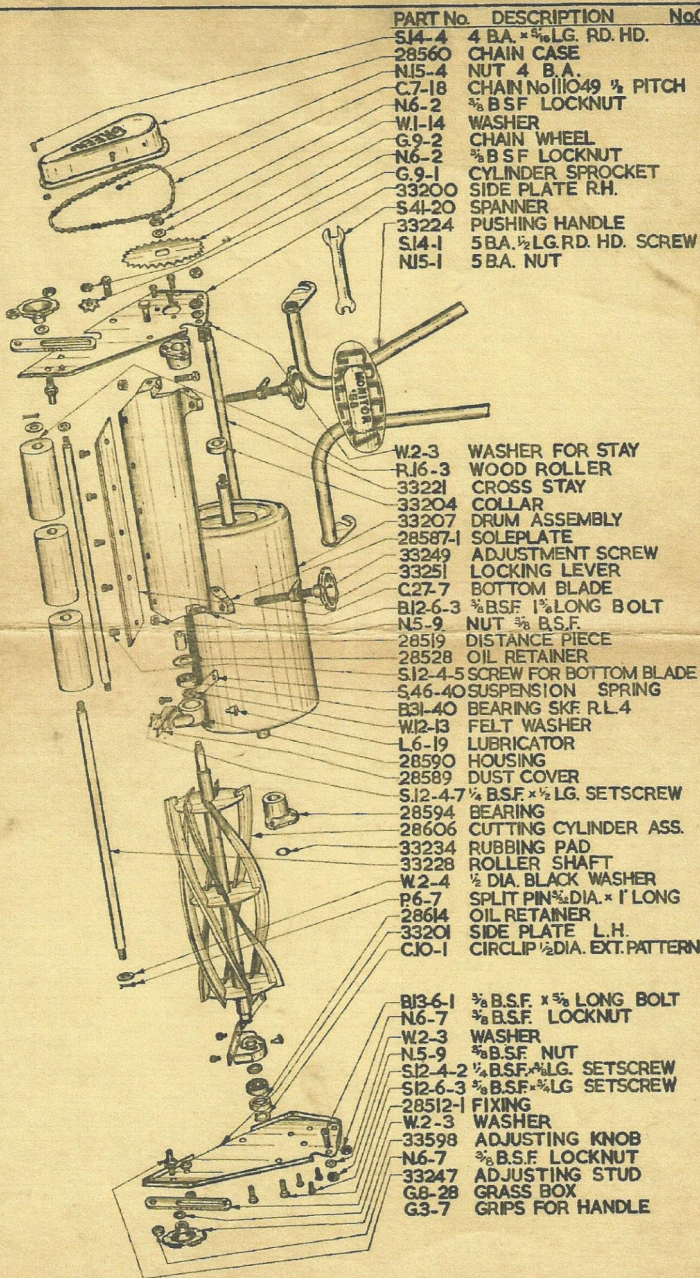

PART No.	DESCRIPTION	No. OFF
S14-4	4 BA. x 3/8 LG. RD. HD.	2
28560	CHAIN CASE	1
N15-4	NUT 4 B.A.	2
C7-18	CHAIN No. 110/49 1/2 PITCH	1
N6-2	3/8 B.S.F. LOCKNUT	1
W1-14	WASHER	1
G.9-2	CHAIN WHEEL	1
N6-2	3/8 B.S.F. LOCKNUT	1
G.9-1	CYLINDER SPROCKET	1
33200	SIDE PLATE R.H.	1
S41-20	SPANNER	1
33224	PUSHING HANDLE	1
S14-1	5 BA. 1/2 LG. RD. HD. SCREW	1
N15-1	5 BA. NUT	1
W2-3	WASHER FOR STAY	4
R16-3	WOOD ROLLER	3
33221	CROSS STAY	2
33204	COLLAR	1
33207	DRUM ASSEMBLY	1
28587-1	SOLEPLATE	1
33249	ADJUSTMENT SCREW	2
33251	LOCKING LEVER	2
C27-7	BOTTOM BLADE	1
B12-6-3	3/8 B.S.F. 1 1/2 LG. BOLT	2
N5-9	NUT 3/8 B.S.F.	2
28519	DISTANCE PIECE	1
28528	OIL RETAINER	1
S12-4-5	SCREW FOR BOTTOM BLADE	5
S46-40	SUSPENSION SPRING	2
B31-40	BEARING SKF R.L.4	2
W12-13	FELT WASHER	2
L6-19	LUBRICATOR	2
28590	HOUSING	2
28589	DUST COVER	1
S12-4-7	3/8 B.S.F. x 1/2 LG. SETSCREW	4
28594	BEARING	2
28606	CUTTING CYLINDER ASS.	1
33234	RUBBING PAD	1
33228	ROLLER SHAFT	1
W2-4	1/2 DIA. BLACK WASHER	2
P6-7	SPLIT PIN 3/8 DIA. x 1" LONG	2
28614	OIL RETAINER	1
33201	SIDE PLATE L.H.	1
CJO-1	CIRCLIP 1/2 DIA. EXT. PATTERN	1
B13-6-1	3/8 B.S.F. x 3/8 LONG BOLT	2
N6-7	3/8 B.S.F. LOCKNUT	4
W2-3	WASHER	2
N5-9	3/8 B.S.F. NUT	2
S12-4-2	3/8 B.S.F. 3/8 LG. SETSCREW	6
S12-6-3	3/8 B.S.F. 3/8 LG. SETSCREW	4
28512-1	FIXING	2
W2-3	WASHER	2
33598	ADJUSTING KNOB	2
N6-7	3/8 B.S.F. LOCKNUT	2
33247	ADJUSTING STUD	2
G8-28	GRASS BOX	1
G3-7	GRIPS FOR HANDLE	2