

# QUALCAST

Concorde RE30X / RE35X

**OPERATING  
INSTRUCTIONS**

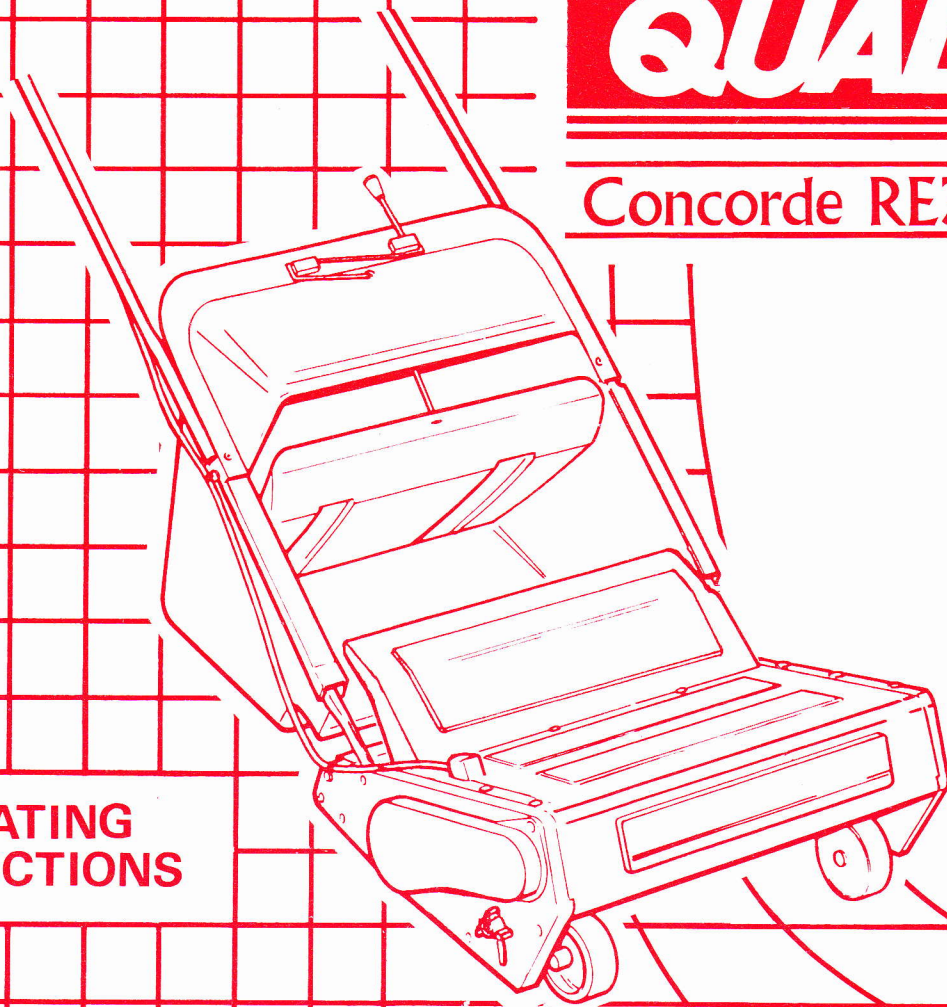



# Assembly

- 1 Remove the mower from its carton and check it. Contact your supplier if it is damaged.
- 2 Insert the flattened part of the handle bottom into the gaps between the mower sideplates and the handle brackets (A). Next, push the plastic pivot pin (C) through the hole and secure with the spring clip (D).

Repeat this procedure for the opposite side of the mower.

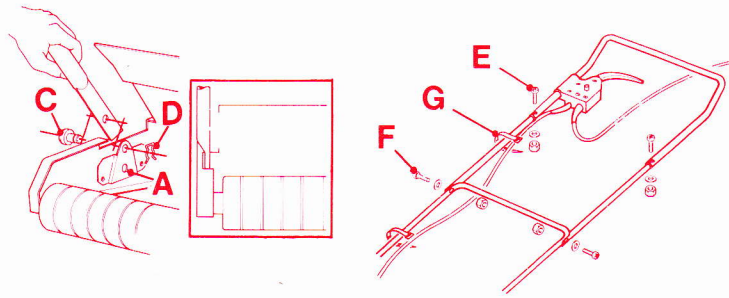

- 3 Assemble the centre sections to the top section using the nuts, washers and bolts supplied, (E) longest length - coloured black. Finally, fit this top and centre assembly to the lower section using the nuts, washers and bolts provided, (F) shortest length - plain.

Ensure the electric cable is not pinched in the joints. The electric switch should be on the right hand side. Make sure all the nuts and bolts are fully tightened.

- 4 Finally clip the cable to the handle with the cable ties provided (G).

# Electrics

It is recommended that for increased electrical safety, a high sensitivity Residual Current Operated Circuit Breaker (also referred to as a Residual Current Device or RCD) is used. Suitable portable units are:-

MK Electric Limited	Safeguard
Dorman Smith Britmac Limited	Model PELO
Federal Electric Limited	Model EL 1630 PSC

If you wish to have a fixed installation as part of the housewiring, a suitably qualified electrician should be consulted.

Safe working practice should always be used, since even with an R.C.D., safety cannot be guaranteed. Ideally, wear shoes with rubber or man made soles.

Check your R.C.D. every time you use it.

The mower is double insulated for safety and therefore, no earth connection is required. The operating voltage is 240V a.c. 50Hz. The cable provided should be fitted with a suitable plug with connections as shown. The mower must be protected by a 3A fuse if a 13A (BS 1363) plug is used, or if any other type of plug is used, by a 5A fuse either in the plug or adaptor or at the distribution board. This fuse is for appliance protection only and should not be relied upon for personal protection. Always disconnect from the mains before examining or adjusting your mower.

To rewire the switch or to fit a new mains supply or intermediate cable, see the notes next to the exploded view.

## ⚠ IMPORTANT

The wires in the mains lead are coloured in accordance with the following code:-

BLUE-NEUTRAL

BROWN-LIVE

As the colours of the wires in the mains lead of the mower may not correspond with the coloured markings identifying the terminals in your plug, proceed as follows:

THE WIRE WHICH IS COLOURED BLUE MUST BE CONNECTED TO THE TERMINAL WHICH IS MARKED WITH THE LETTER 'N' OR COLOURED BLACK. THE WIRE WHICH IS COLOURED BROWN MUST BE CONNECTED TO THE TERMINAL WHICH IS MARKED WITH THE LETTER 'L' OR COLOURED RED.

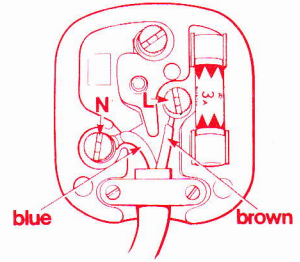

## Extension cable

Only use an approved extension cable with your mower. Cable extensions should be connected with a suitable connector, as shown. Ensure outer sheath of cable is securely fixed by cable clamp. Cables and plugs (Q02016) are available from your nearest Service and Parts Centre and the Approved Service Agents listed in the 'After Sales Service' information.

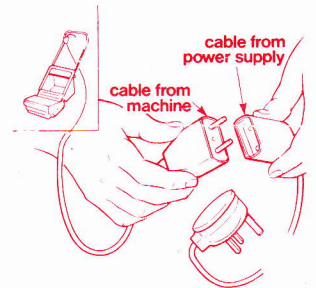

## ⚠ WARNING

For safety, it is essential that the connector section containing the two projecting pins should be fitted to the cable attached to the mower, as illustrated.

## Safety Rules

**IMPORTANT - ALL POWERED MACHINERY IS POTENTIALLY DANGEROUS IF USED INCORRECTLY. WE RECOMMEND THAT YOU SHOULD READ THESE INSTRUCTIONS BEFORE USING THE MOWER ESPECIALLY SECTIONS CONCERNING SAFETY.**

- ⚠ Make sure that the lawn is clear of sticks, stones, bones, wire etc. They could be thrown by the blades.  
*NOTE: Damage to the cutters is excluded from Warranty.*
- ⚠ Always be sure the mower and cutters are in a safe operating condition. Use only genuine replacement parts supplied and guaranteed by the manufacturer.
- ⚠ Your mower is protected against the effects of light rain or moisture, but always avoid exposure to heavy rain. Never wash it with water. Do not mow in rain or wet ground conditions.
- ⚠ Never lift the mower, turn it over, do any cleaning or checking whilst it is still operating, or is still plugged into the electricity supply.
- ⚠ Do not mow whilst people, especially children, or pets are in the mowing area. Do not allow children or people unfamiliar with these instructions to operate the mower.
- ⚠ Always wind cables in figure of '8', starting at the mower end of the cable and working towards the plug, this will avoid 'kinking'.

- ⚠ It is important that the cable remains free at all times. Position it so that it will not get snagged. DO NOT tug on the supply cable. Always ensure that there is slack in the cable. Never tug it or put it under tension. Resulting damage to the conductors or internal cable insulation may not be visible and could be very dangerous.
- ⚠ Always keep the cable away from the mower when mowing. Disconnect from the mains and examine the cables regularly for damage or ageing and replace where necessary. Do not use the mower with a faulty cable.
- ⚠ Disconnect the mower from the mains when it is unattended.
- ⚠ Check for loose nuts or bolts regularly as these can fall into the cutters.
- ⚠ If the mower strikes a solid object, stop, remove the plug from the electricity supply and inspect the cutters for damage. Repair any damage before re-starting the mower.
- ⚠ DANGER - Keep feet and fingers well away from moving blades and do not mow barefoot or in open sandals.
- ⚠ Be particularly careful of your footing on slopes or wet grass, and never cut the grass by stepping backwards and pulling the mower towards you.



# How to use your mower

Please check the cutting action of your mower before you first use it. All new mowers are checked before despatch from our factory but occasionally they go out of adjustment during transit. To reset the cutters see 'Cutter Adjustment' below. Poorly set cutters will give a rough, ragged looking finish.

## Grassbox & Compactor

The grassbox nestles in the 'U' shaped handle bottom with the lugs fitting over the crossbar.

A grass compactor is fitted to the grassbox to increase its capacity. When the grassbox is empty, the compactor lies flat in the bottom of the box. As the box fills, the compactor can be pulled up and secured to compress the clippings by winding the cord (H) round the retainer (J).

To mow without collecting grass, fit the grassbox so the front lip rests on the deflector plate. (This ensures that the clippings are safely deflected onto the ground.)

## Starting

The mower features a safety lock button designed to prevent accidental operation of the cutting system. To start the machine:-

1. Depress the safety button and hold.
2. Squeeze switch lever.
3. Release safety button.

Once the lever is released it becomes locked again and the mower stops automatically.

## Mowing

Place the surplus cable on the lawn close to the starting point. Trail the electric cable over your shoulder and/or hold a short loop of cable in your hand, to help keep it behind you. Always work away from the supply cable to avoid loose cable on the uncut grass where it would interfere with your mowing. At the end of each swath, switch off and turn the mower in alternate directions, throwing the cable to the opposite side for each succeeding cut. Take care not to get the cable entangled in the cutters. Do not work in a circular path.

It is important that the cable remains free at all times. Position it so that it will not get snagged.

**⚠ DO NOT tug on the supply cable, always ensure that there is slack in the cable, never tug it or put it under tension. Resulting damage to the conductors or internal cable insulation may not be visible and could be very dangerous.**

## ADJUSTMENTS & MAINTENANCE

### Height of Cut Adjustment

**⚠ Always unplug the mower from the mains before adjusting the height of cut.**

The height of cut can be set at three positions, 11mm, 19mm and 27mm. To adjust, loosen the nuts (K) on each side of the mower, move the wheels to the required height and re-tighten the nuts securely. It is essential that the same position is selected on each side.

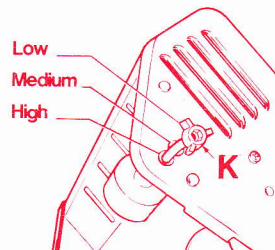

### Cutter Adjustment

The cutters should be adjusted if the mower does not give a clean even cut.

**⚠ Unplug the mower from the mains before handling or adjusting the cutters.**

**⚠ DANGER — The cutting blades are sharp and could cut your fingers.**

To adjust the cutters:-

1. Turn the mower upside down.
2. Adjust the bottom blade closer to the cutting cylinder by turning the screws (L) clockwise on each side of the mower a

*little at a time.* The blades are correctly adjusted when the cutting cylinder *lightly* brushes the bottom blade evenly across its full width as the cylinder is turned. (The cutters work like a pair of shears. As a test, correctly adjusted cutters will cut a piece of good quality writing paper at any point across the width of the blades).

**⚠ DO NOT ADJUST THE BOTTOM BLADE TOO TIGHTLY TO THE CUTTING CYLINDER** as this will overload the motor and may damage it and the bearings.

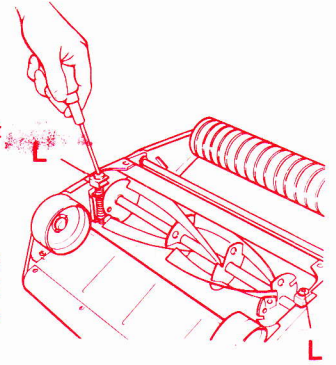

Inspect the blades and if they are badly damaged, bent or worn, they should be changed. New bottom blades are available from our Service Agents and may be easily fitted following the instructions on the pack. Contact one of our Approved Service Agents or your nearest Qualcast Service and Parts Centre if you require assistance or parts.

## Drive Belt Adjustment and Replacement

The drive belt is tensioned before the mower leaves our factory. The belt tension should be occasionally checked as below. An incorrectly tensioned belt will either wear rapidly if very loose, snap or burn out the motor if very tight. The drive belt is also a fail safe device designed to protect the motor if the cutters strike a hard object. It is manufactured to close tolerances, using glass fibre bonded in nylon and neoprene. To preserve its strength, do not pinch, crimp or deform it.

**⚠ Before adjusting the belt, unplug the mower from the mains.**

To check and adjust the belt or to fit a new belt:-

- 1 Remove the drive cover. (on the right hand side of the mower)
- 2 Loosen the motor screws (M) & (N) Do not remove completely or the motor will fall inside the mower. (If fitting a new belt, move the motor backward and slide the belt over the toothed pulleys)
- 3 Tension the belt by using firm *hand* pressure to push the motor pulley (P) away from the large pulley. Ensure that the raised black pad around the motor shaft is fully located in the sideplate cut-out. Tighten screw (N) then screw (M) to lock the motor, whilst maintaining the tension on the belt.

**⚠ Do not use a screw driver or similar object to lever the motor as this will overtension the belt — firm hand tension is enough.**

The belt tension is correct when the free movement of the belt is 4mm or less.

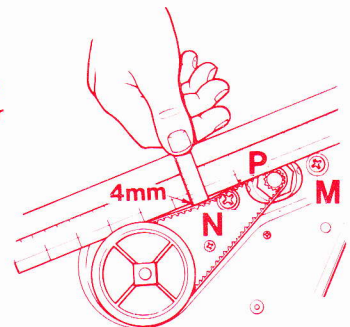

## Maintenance

**⚠ Always unplug the mower from the mains before handling or adjusting the mower mechanism.** Check that the mower gives a good clean finish. If it does not, check that the cutters are correctly set and not badly damaged.

## After Cutting

Keep the air filter on the left side of the mower clear of debris. The mower can be wiped down with a dry cloth but **DO NOT USE WATER.** Check for loose nuts and bolts. The cutting cylinder bearings may be oiled occasionally but other parts should *not* be oiled.



## Motor Pinion

If your motor pinion becomes damaged then you should take your mower to a service agent for repair.

## To Rewire the Switch

1. Insert a 1mm diameter pin in the same hole as the wire.
2. Pull out the wire.
3. Remove the pin.
4. Trim ¼" of insulation off the end of each wire of the new lead.
5. Twist the strands of each wire together.
6. Insert each wire fully into the switch.
7. Ensure outer sheath of cable is securely fixed by cable clamp.

## To Rewire the Intermediate Cable

Should the intermediate cable become damaged, it must be replaced with a special cable with terminals. This is only obtainable from your local Qualcast Service Agent. (See separate list).

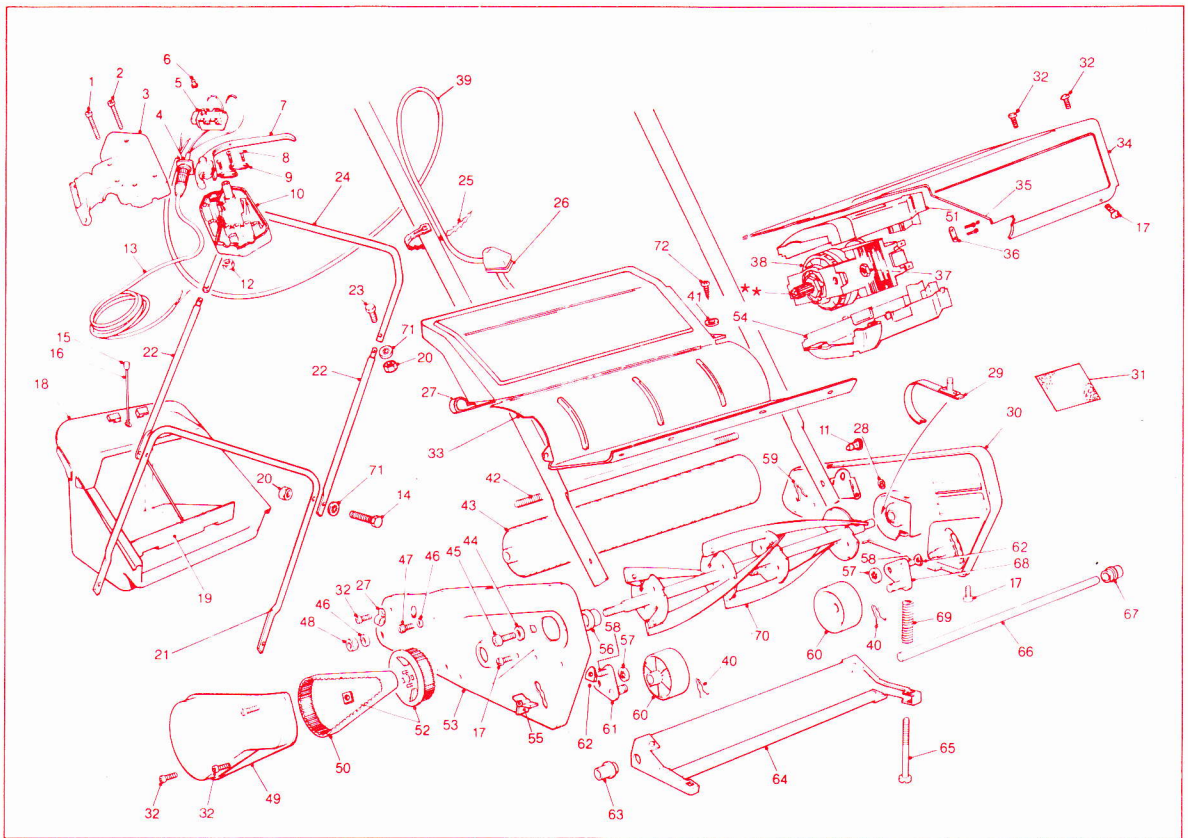

**IMPORTANT:** It is essential when ordering spare parts that the following information is given:-

- a) Model and Serial Number of the mower
- b) Part Number, NOT illustration reference number.
- c) Description of part.

E.G. The drive belt is illustration number 50 - thus the part number is T43506 - Drive belt pack

**NOTE:** Where parts are made left hand (L.H.) and right hand (R.H.), these are determined as the mower is pushed.

Item	Description	Part No.	Qty.
1	Screw (switch - long)	T40945	2
2	Screw (switch - short)	T42036	3
3	Switch housing (upper)	T45903	1
4	Cable guard	T44500	1
5	Switch assembly	T44764	1
6	Button seal	T44206	1
7	Lever	T44880	1
8	Screw (cable clamp)	T44191	3
9	Cable clamp	T46290	2
10	Switch housing (lower)	T45904	1
11	Pivot pin (plastic)	T46340	2
12	Nut (switch)	T41159	5
13	50' cable	Q02009	1
14	Bolt (handle securing)	T46338	2
15	Knob	T44862	1
16	Cord	T43833	1
17	Screw (plastic motor cover/deflector)	T45575	10
18	Grassbox assembly (30cm)	T45906	1
	Grassbox assembly (35cm)	T45907	1
19	Compactor (30cm)	T43301	1
	Compactor (35cm)	T43302	1
20	Nut (handle securing)	T42020	4
21	Handle bottom - 30cm	T46327	1
	Handle bottom - 35cm	T46328	1
22	Handle centre	T46435	2
23	Bolt (handle securing)	T46339	2
24	Handle top	T45546	1
25	Cable cleat	T40567	2
26	Grommet	T46080	1
27	'P' clip	T42806	2
28	Circlip	T43899	2
29	Tee nut leaf spring assembly	T43913	2
30	Sideplate assembly (L.H.)	T46335	1
31	Filter	T40516	1
32	Screw (self tapping)	T41953	10
33	Lower motor cover/deflector guard 30cm	T46341	1
	Lower motor cover/deflector guard 35cm	T46342	1
34	Motor cover upper (30cm)	T42620	1
	Motor cover upper (35cm)	T41926	1
35	Screw (self tapping)	T40573	2
36	Cable clamp (motor)	T40562	1
37	Nut (motor securing)	T40589	2
38	Motor assembly (30cm) (includes pinion and rollpin)	T44567	1
	Motor assembly (35cm) (includes pinion and rollpin)	T44568	1
39	Intermediate cable	T44888	1
40	Spring clip	T41251	2
41	Washer	T46127	1
42	Spindle (30cm)	T43440	1
	Spindle (35cm)	T43446	1
43	Roller rear (30cm)	T43911	1
	Roller rear (35cm)	T43912	1
44	Washer (motor securing)	T40590	2

45	Screw (motor securing)	T40588	2
46	Washer (shakeproof)	T41024	4
47	Bolt (stretcher)	T43449	2
48	Nut	L18117	2
49	Drive cover	T41916	1
50	Drive belt pack	T43506	1
51	Motor sleeve upper	T44504	1
52	Large pulley pack	T42727	1
53	Sideplate assembly (R.H.)	T46336	1
54	Motor sleeve lower	T45139	1
55	Nut - triwinged	T46302	2
56	Dirt seal (30cm)	T40530	1
57	Ratchet plate	T42867	2
58	Bolt	T40736	2
59	Circlip	T45870	2
60	Wheel	T41931	2
61	Roller carrier assembly (R.H.)	T46280	1
62	Spacer	T42791	2
63	Bush (large)	T45585	1
64	Bottom blade pack (30cm)	Q02070	1
	Bottom blade pack (35cm)	Q02071	1
65	Screw (bottom blade adjust)	T43163	2
66	Stretcher (30cm)	T45591	1
	Stretcher (35cm)	T45593	1
67	Bush spring assembly	T45586	1
68	Roller carrier assembly (L.H.)	T46279	1
69	Spring (bottom blade adjust)	T43125	2
70	Cylinder assembly (30cm)	T43710	1
	Cylinder assembly (35cm)	T45615	1
71	Shakeproof washer	L18174	4
72	Screw (self tapping)	T42978	2
	Deflector guard transfer (30X)	T45641	1
	Deflector guard transfer (35X)	T45642	1
	Motor cover transfer	T45643	1
	Grassbox transfer	T45645	1
	Warning transfer	T46657	1
	Warning transfer	T46658	1

\* Items indicated on the drawing with an asterisk are available only to Service Agents

*	Pinion	T44827	1
*	Roll pin	T44492	1

## If your mower fails to work



If the mower still fails to operate or works intermittently, do not continue to hold the trigger in the 'on' position, as this may cause further damage to the components.

Check the following:-

1. Is the mains socket 'live'? Test by trying another appliance.
2. Is the mower plug connected correctly?
3. Has the fuse in the mower plug failed? Replace with a new fuse and try again.

Unplug the mower from the mains. No further checks must be made to find the fault with the mower plugged in. SUCH ACTION COULD BE DANGEROUS.

4. Are the cutters jammed? Clear the blockage and try again.

If the mower still fails to work or if the fault is intermittent then it may lie within the mains cable. Do not attempt to find this fault but seek advice from a Qualcast Service And Parts Centre or an approved Service Agent. Select an agent from the list with an 'E' (electrical) approval.

Note:- Remove your mains plug from the cable before returning the mower for service or repair.

## Winter Storage

Store the mower in a dry place, preferably off the ground. Clean off any debris and wipe metal parts with an oily rag. Check all nuts and bolts are tight and replace any worn parts.

## Warranty

This is as stated on the guarantee.

Every effort is made to ensure that these instructions are up-to-date. However, due to our policy of continuous product development, changes in production specification may have been made. If in doubt, please contact your nearest Qualcast Service and Parts Centre or a Qualcast Service Agent.

This product is manufactured to comply with the Radio Interference Requirements of EEC directive 82/499/EEC.

## Spare Parts

The following spares are available in kits complete with full instructions to assist DIY replacement:-

Q02070	Bottom Blade replacement kit RE30X
Q02071	Bottom Blade replacement kit RE35X
T43506	Drive Belt replacement kit
T42727	Large Pulley pack
Q02010	Concorde Green aerosol spray paint,

All parts and service assistance are available from our Approved Service Agents and Service Centres (See separate list supplied with your machine). Select an Agent with an 'E' (electrical) approval.

## Unique Optional Features

Qualcast have now developed two unique attachments to your Concorde RE for easier lawn care.

Lawn Edge Trimmer - converts your mower into a powered lawn edge trimmer to produce a quality cut equivalent to the very best garden shears.

Lawn Rake Kit - turns your mower into a powered lawn rake to lift out moss, thatch and other lawn debris and rake up leaves without the hard slog.

Ask your retailer for further details.

## **WARNING**

**SWITCH OFF, REMOVE PLUG FROM  
MAINS BEFORE ADJUSTING,  
CLEANING OR IF CABLE IS ENTANGLED.  
THE BLADES CONTINUE TO ROTATE  
FOR A FEW SECONDS AFTER THE  
MACHINE IS SWITCHED OFF.**

**Qualcast Garden Products Limited,**

*Sunnyhill, Derby, England. DE3 7JT.*

*Tel. 0332 (Derby) 760202 : Telex: 377514*

**T46346 (N) A4**

*Printed in England*